

A wide-angle photograph of a modern urban waterfront in Rotterdam. On the left, there are multi-story residential buildings with large windows and balconies. A paved promenade runs along the water's edge, featuring a large tree, streetlights, and people walking and sitting. In the background, a cable-stayed bridge spans the water, and several modern skyscrapers are visible under a blue sky with light clouds. The overall atmosphere is bright and contemporary.

Rotterdam

City development.

11th April 2025

Mattijs van Ruijven

Rotterdam is a modern city.



Photo: Aiste Rakauskaitė.

Rotterdam is changing.



Change is part of history of Rotterdam.



City centre after 14th may 1940.

258 hectares demolished.

850 people died.

80.000 people lost their home.

Rebuilding Rotterdam the modern way.



Photo: MvR.

Rotterdam – experiments and interventions.



Photo: Ossip van Duivenbode

Rotterdam – experiments and interventions.



Demography is changing.



More than 170 nationalities – 50 % one-person households.

Photo: Beeldbank Rotterdam.

Rotterdam is growing.

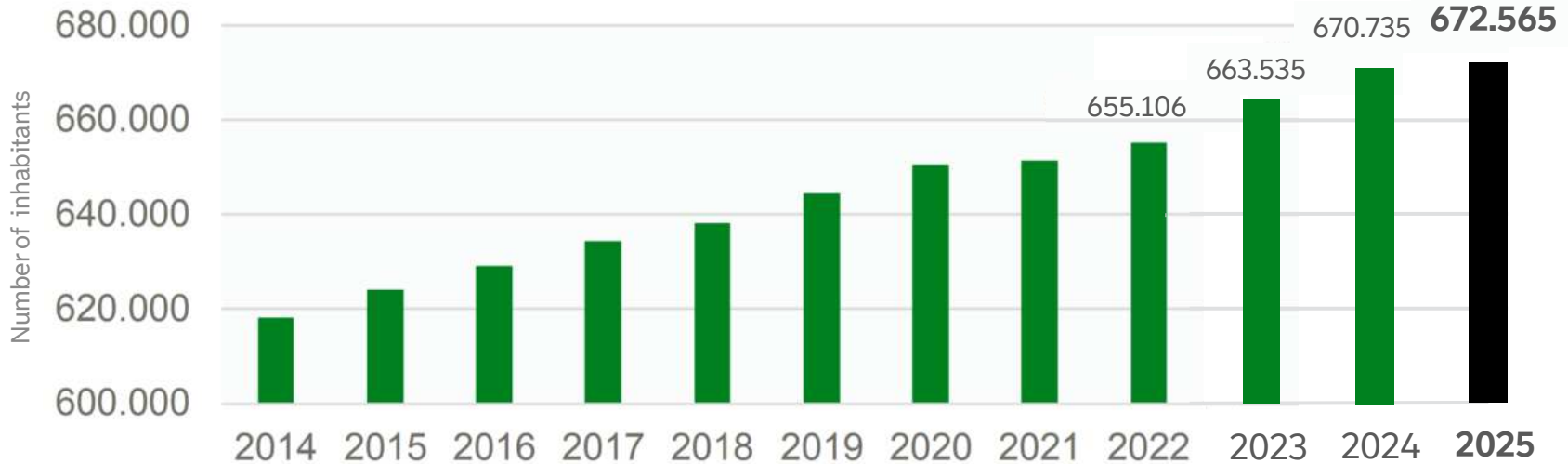

© Rotterdam - Onderzoek010.nl

■ 1 january ■ 1 january 2025

Towards 740.000 inhabitants in 2040.

Metropolitan region: 1.2 million inhabitants.

(Schiedam, Vlaardingen, Capelle, Barendrecht, Spijkenisse, etc.)



City vision – we choose “good growth”.



Making the city together.



Use our identity and existing qualities.
(social and physical)



Incorporate 5 perspectives.
(compact, productive, sustainable, inclusive and health)

City vision.

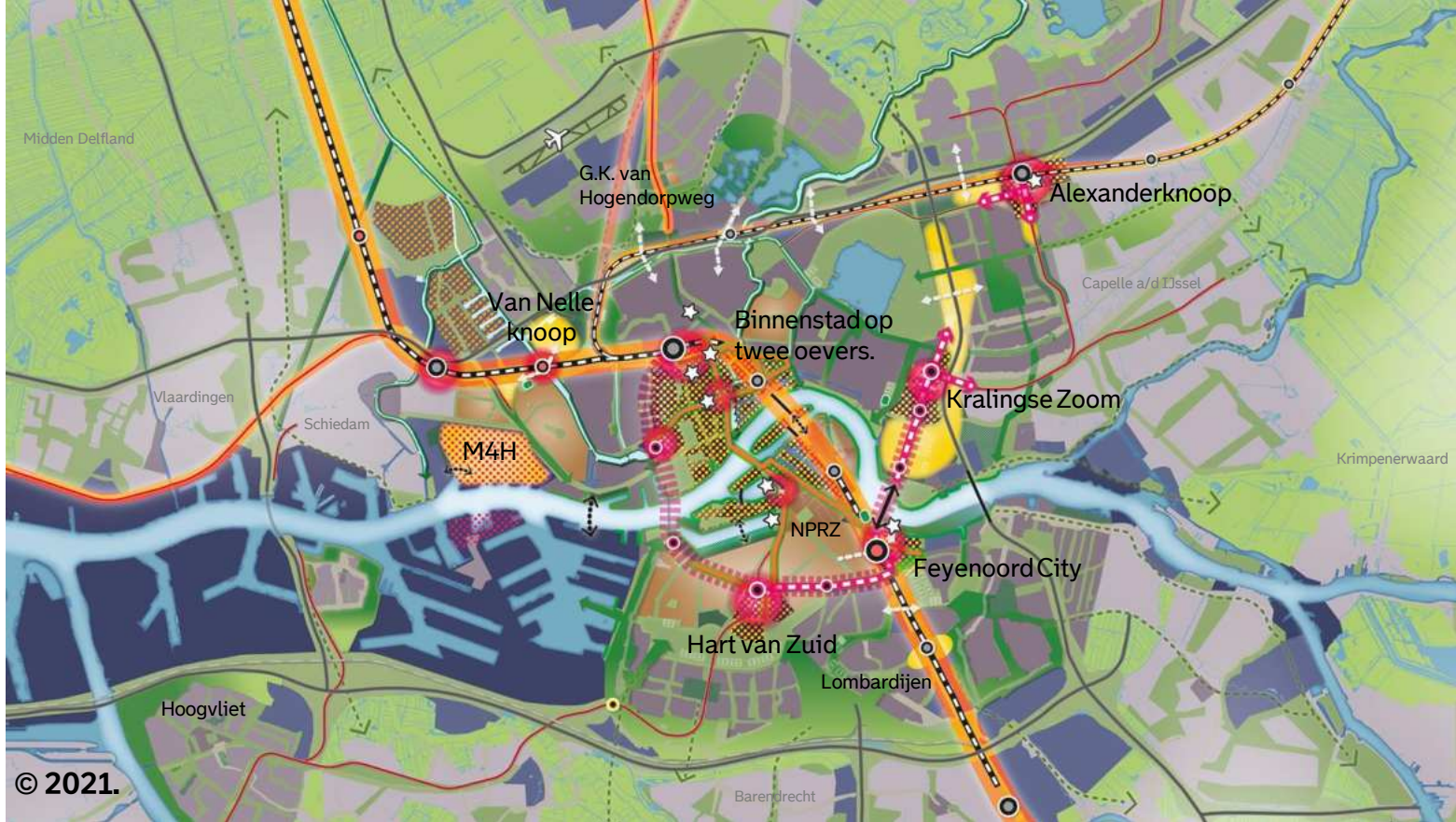

City development Rotterdam.

Densify the existing the city.



Little C, Tuchinskipark - Coolhaven.

Photo: Francisco van Jole.

Use existing qualities in development.



Fenix I – MEI Architects

Katendrecht.

City at eye level.



Barcode Architects.

Wijnhaven, Maritiem District.

Groundfloor and first layers are the most important in highrise.

Transition of mobility.

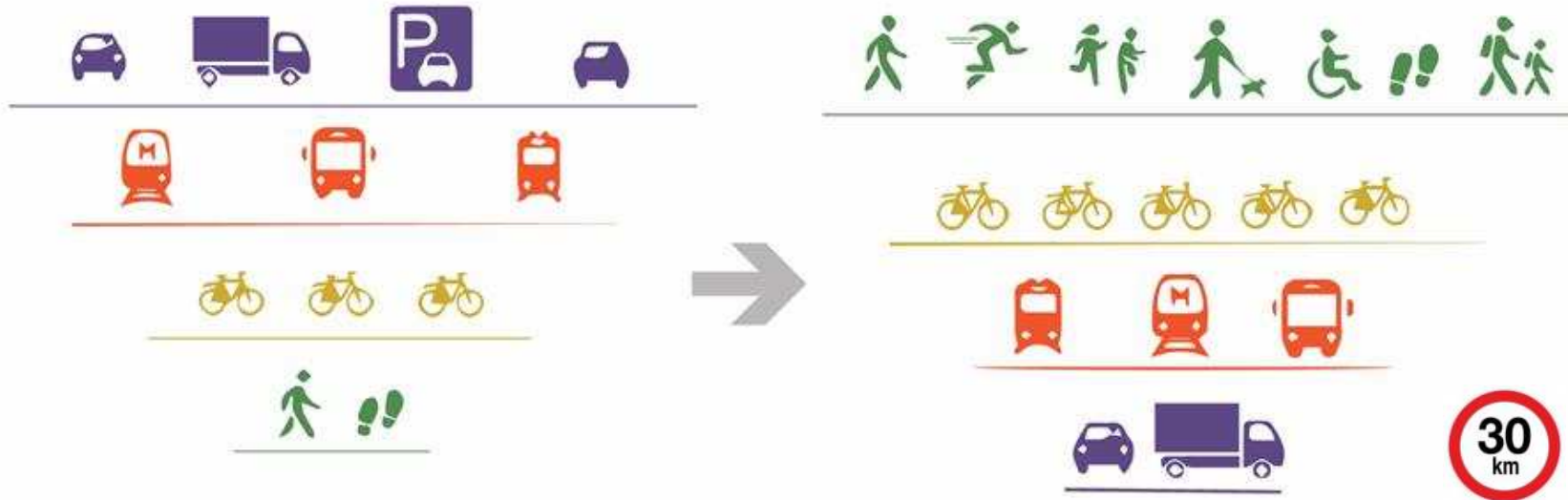

Transformation of Hofplein.



1 of 7 cityprojects: Hofplein

More green
Health
Mobility balance
Reduce heat island
Quality of life
City lounge

Transformation Hofplein.



1 of 7 cityprojects: Hofplein

Image: Juurlink + Geluk

Transformation of Hofplein.



7 Stadsprojecten: Hofplein

Image: Juurlink + Geluk

Transformation of Hofplein.

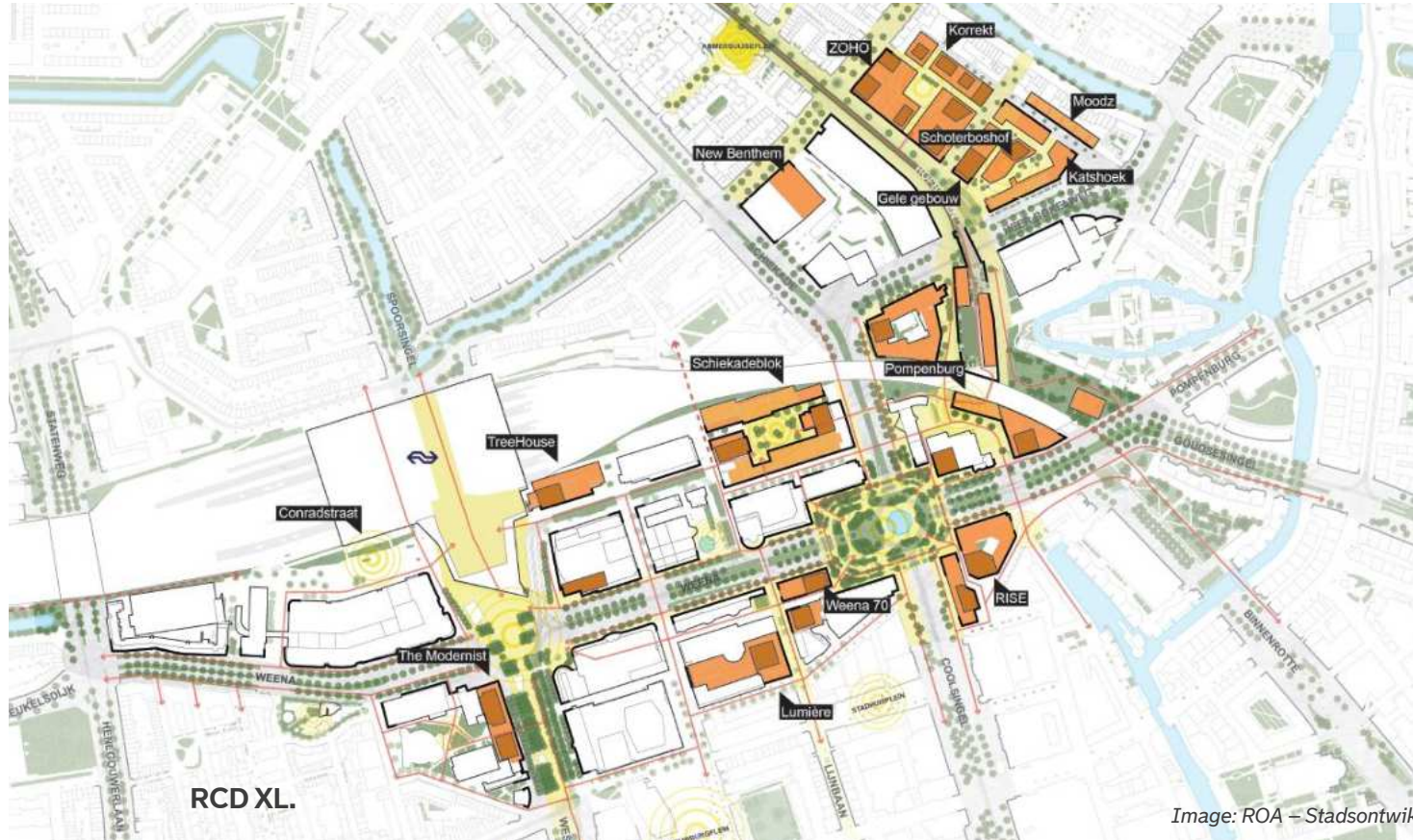

Image: ROA – Stadsontwikkeling.

Challenges of today – Climate.



Photo: Joey Engelen

Challenges of today – Climate.



Rainfall.



Flooding.



Heat.



Drought.



Groundwater.



Land subsidence.



ROTTERDAM
WEATHER WISE.

Rethinking actions from the past.



Canal filled with debris from the bombing.

© H.F. Grimeijer / Stadsarchief Rotterdam.

Urban waterbuffer in development.



Gooilandsingel – Hart van Zuid.

Design research.



Current situation

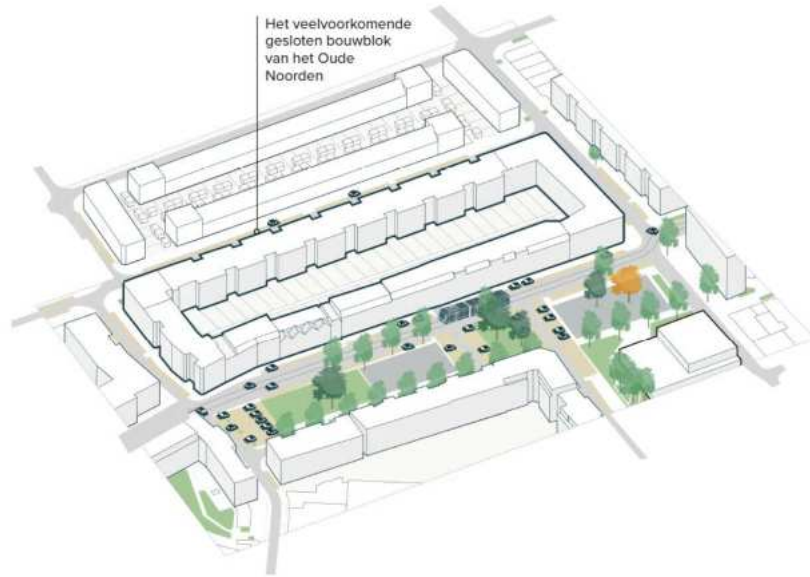

Possible future image

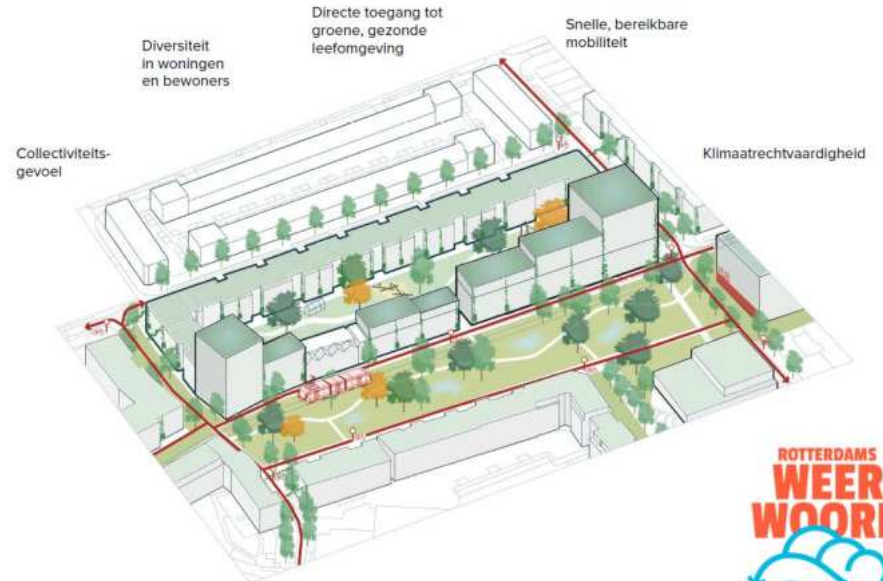

Future-proof neighbourhoods – improving, greening and densifying.



Challenges of today – Social development.



© Voel je thuis huis.

Foto: Anne Boukema.

Challenges of today – systems.



Photo: Marco de Swart.

Rotterdam – Paris proof / net zero carbon emission.

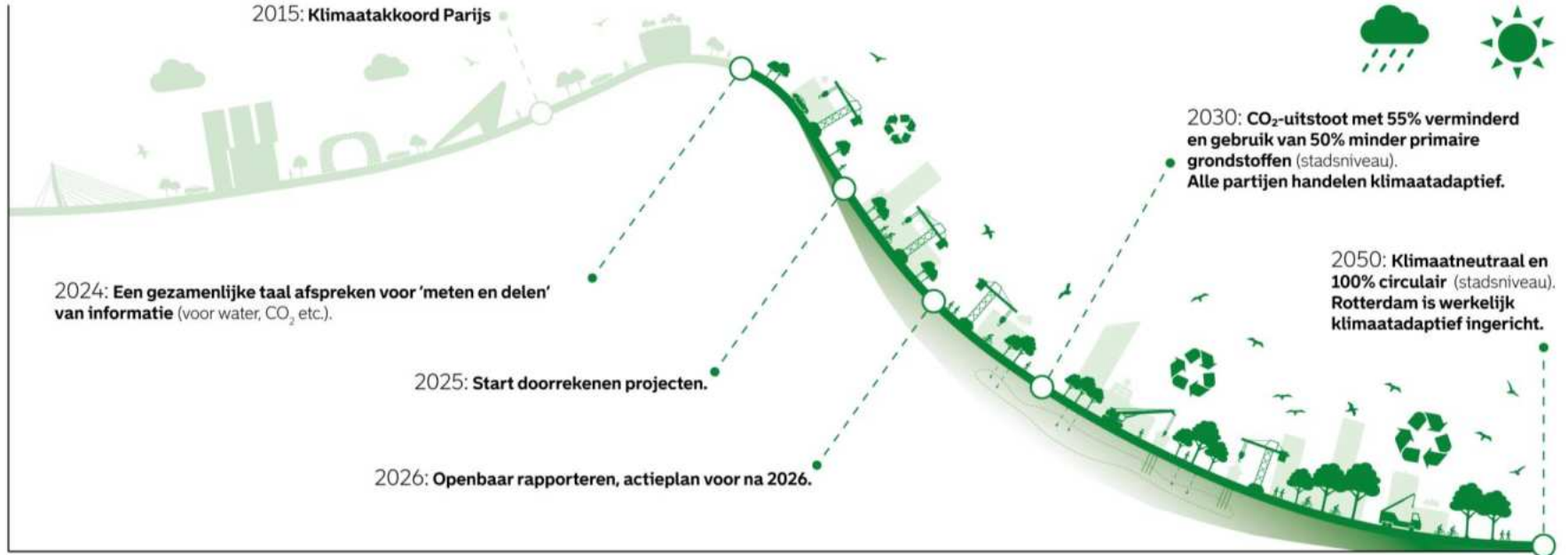

Leren, meten doen – learn, measure, act!

Image: Stadsontwikkeling

Development with added value.



Investing in existing neighborhoods.



City development Rotterdam.

Investing in existing neighborhoods.



Malieklos – Woonstad / DP 6 architectuurstudio.

Photo: Jan de Groen.

Affordable housing.
(55% today => 65% in 2026)

Malieklos won the Architecture-price in 2022, social housing.

Making neighborhoods climate proof.



Community engagement – stimulate façade gardens.

Part of green strategy for the whole city.

Transformation of Hofbogen.



Photo: Ossip van Duivenbode



Photo: Hofbogen Rotterdam.

Focus on education and work.



Focus on education and work.



Photo: Beeldbank Rotterdam.

One city on both sides of the river.



New city bridge crossing the river.

Foto: MvR.

Major development – Oostflank.

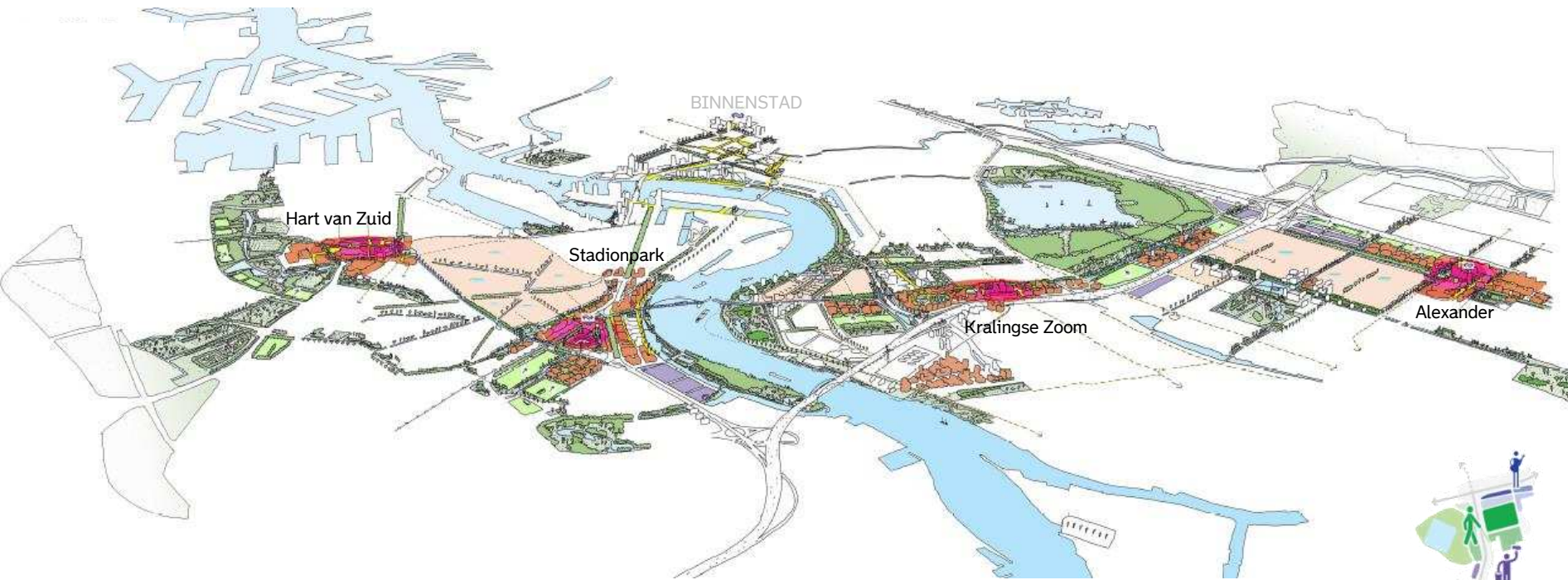

Connecting different parts of the city. Development of 40.000 – 50.000 homes.



Feyenoord city.



Connecting existing neighborhoods.



Hillesluis: Boulevard Zuid – Beijerlandse laan

Photo: Eric – Gers! Rotterdam

River as central park of Rotterdam.



Major development – M4H.



**Innovation quarter for port and city.
Connected to surrounding residential
areas. Mixing living and working.**

Image: Stadsontwikkeling.



Kop van Zuid – Rijnhaven.



Rijnhaven.
±3.000 dwellings.
18 hectare park.

Innovation in highrise – Rijnhaven.

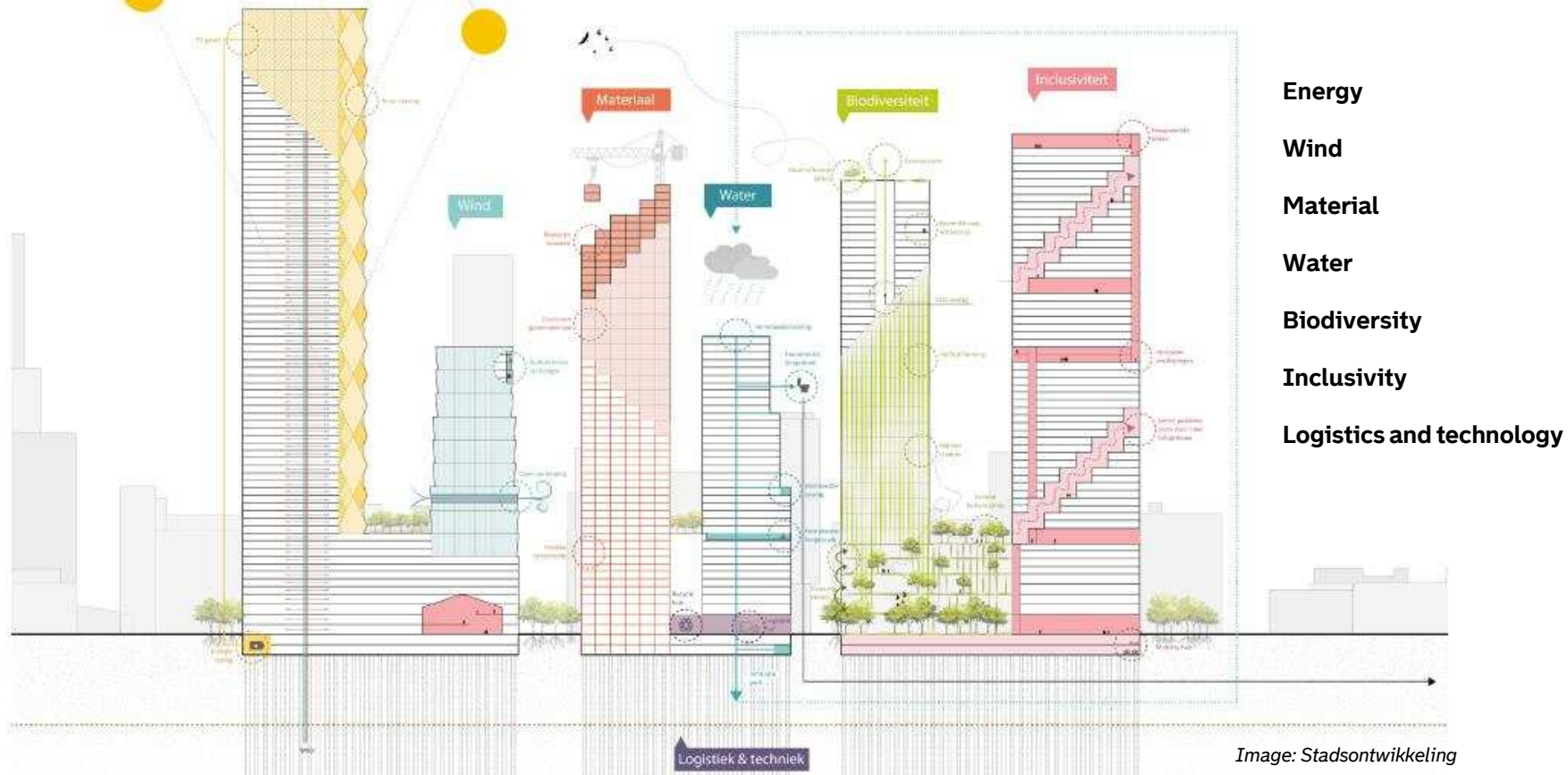

Kop van Zuid – Rijnhaven.



Photo: Jeroen van Dam.



RESILIENT
ROTTERDAM

Making the city together.

www.rotterdam.nl
Mattijs van Ruijven
m.vanruijven@rotterdam.nl